



FIELD OF USE

Timber-to-timber shear connections, both perpendicular and inclined to the vertical plane

- solid timber
- glulam (Glued Laminated Timber)
- XLAM (Cross Laminated Timber)
- LVL (Laminated Veneer Lumber)
- wood-based panels

PACKAGING

Screws HBS+evo Included in the box



STEEL-ALUMINUM

EN AW-6060 aluminum alloy bracket obtained by extrusion and therefore weld-free



SLENDER STRUCTURES

The small dimensions of the side allows to connect secondary joists with limited width (starting from 45 mm)

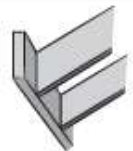

ADJUSTABLE

Available in 2165 mm long pieces, to be cut according to the worksite needs

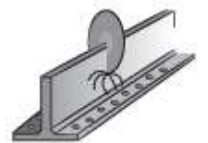



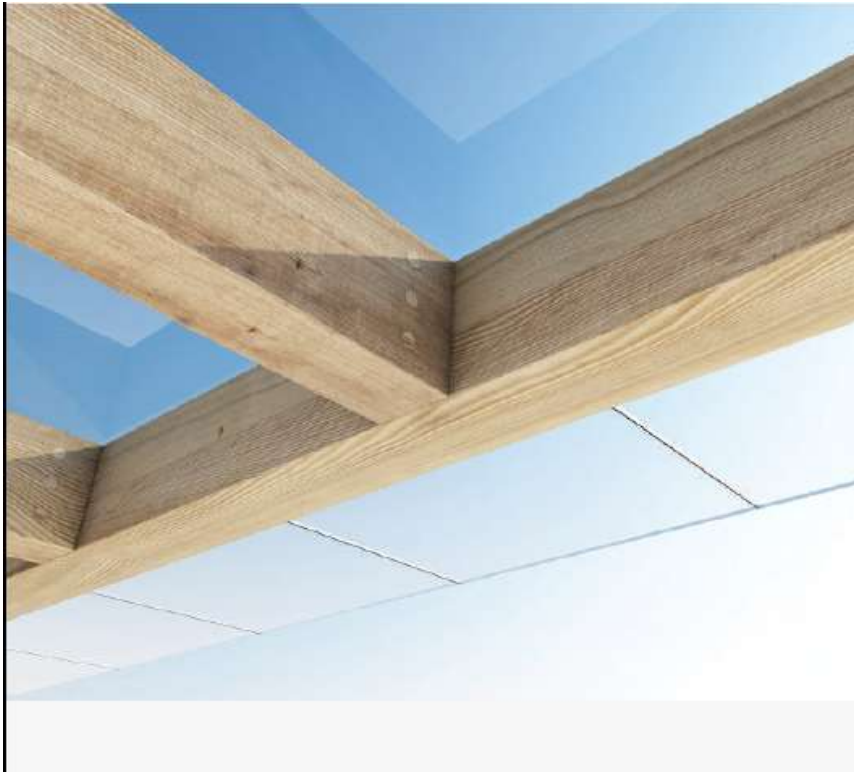

QUICK ASSEMBLING

The fixing, simple and fast, is realized through screws HBS + evo on the main beam and self drilling or smooth dowels on the secondary beam



INVISIBLE

The hidden connection provides a satisfying appearance to the joint and fulfills the fire safety requirements. When adequately protected by timber, it is suitable for outdoor use



SUITABLE FOR ARBORS

Limited dimensions and aluminum higher corrosion resistance, when compared to steel, make the bracket an optimal solution for any kind of outdoor structure



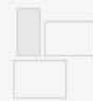

INVISIBLE

The hidden connection provides a satisfying appearance to the joint and fulfills the fire safety requirements. A countersink where the first hole is located, facilitates the introduction of the secondary beam from the top

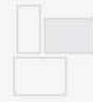

TIMBER - CONCRETE

For applications on reinforced concrete or other uneven surfaces the self-drilling dowels allow a greater installation tolerance when fixing the timber element. Values are certified, tested and consolidated

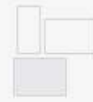

CERTIFIED SAFETY

AluMIDI bracket has been the subject of many research works, studies and international publications, both from theoretical (calculation models) and experimental point of view



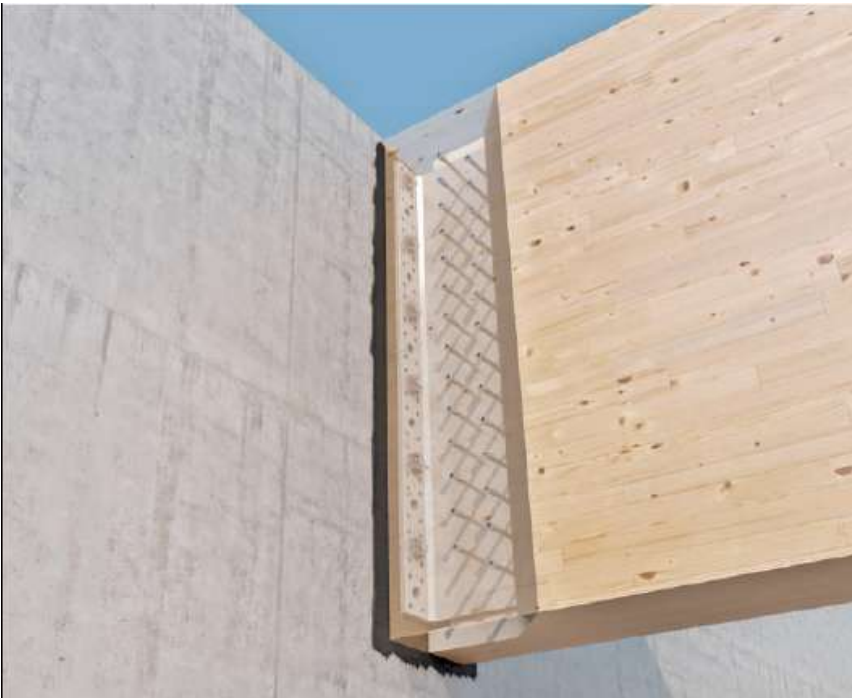

UNMATCHED

The low weight of the steel - aluminium alloy facilitates easy transportation and onsite movements, while guaranteeing a very high strength. Being a hidden joint, it satisfies the fire safety requirements.

STEEL AND CONCRETE

Possible applications regarding reinforced concrete or metal surfaces. Values are calculated, certified and consolidated.

LARGE SCALE STRUCTURES

Ideal for connections between oversize beams or when high strength is required. The version without holes provides free choice when positioning the fasteners.





